

MU 4-ZG/...

Collinear 4 dB Mobile Antenna for the 450 MHz Band

- 4 dB mobile antenna with collinear, stainless steel whip with 8 mm thread joint.
- Models with ZG-mount or MZG-magnetic mount.

DESCRIPTION

- Choice between ZG-mount with FME-connection (supplied without cable) or ZGP4-mount with 4 m factory fitted cable (terminated with FME-connector).
- MZG-models are provided with FME-connection directly on the mount (supplied without cable).
- Choice between general purpose tunable models and permanently tuned models for cellular systems.

Whips from the ZG/ZGP4 mounts and the MZG-mount are **NOT** compatible.

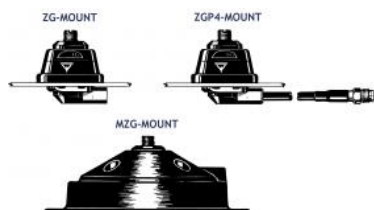

ORDERING DESIGNATIONS

ZG-mount with FME	PRODUCT NO.	ZGP4-mount with 4 m cable and FME-conn.	PRODUCT NO.	[MHz]
Models for general application - tunable with adjustment disc:				TUNING
MU 4-ZG/s	130000972	MU 4-ZGP4/s	130000958	380...410
MU 4-ZG/f	130000957	MU 4-ZGP4/f	130000959	406...430
MU 4-ZG/l	130000963	MU 4-ZGP4/l	130000964	420...450
MU 4-ZG/h	130000960	MU 4-ZGP4/h	130000961	440...470
Models for cellular systems - pretuned, without adjustment disc:				FREQUENCY
MU 4-ZG/CEL4		MU 4-ZGP4/CEL4		414 - 430
MU 4-ZG/CEL3	130000968	MU 4-ZGP4/CEL3	130000971	425 - 440
MU 4-ZG/CEL2	130000967	MU 4-ZGP4/CEL2	130000970	440 - 455
MU 4-ZG/CEL1	130000966	MU 4-ZGP4/CEL1	130000969	450

MZG-mount with FME	PRODUCT NO.	[MHz]
Models for general application - tunable with adjustment disc:		TUNING
MU 4-MZG/s	130000920	380...410
MU 4-MZG/f	130000917	406...430
MU 4-MZG/l	130000919	420...450
MU 4-MZG/h	130000918	440...470
Models for cellular systems - pretuned, without adjustment disc:		FREQUENCY
MU 4-MZG/CEL4		414 - 430
MU 4-MZG/CEL3		425 - 440
MU 4-MZG/CEL2	130001329	440 - 455
MU 4-MZG/CEL1		450 - 470

SPECIFICATION

ELECTRICAL	
MODEL	MU 4-ZG/...
ANTENNA TYPE	Collinear stainless steel mobile whip antenna
FREQUENCY	Models within 380 – 470 MHz
IMPEDANCE	Nom. 50 Ω
POLARIZATION	Vertical
GAIN	4 dB (acc. to EIA RS-329-1)
BANDWIDTH	> 15 MHz @ SWR ≤ 1.5 > 30 MHz @ SWR < 2.5
SWR	≤ 1.3 @ f. res.
MAX. POWER	100 W

INSTALLATION

The antenna whip comprises a $\frac{1}{4} \lambda$ section, a phase shifting coil, and a $\frac{1}{2} \lambda$ section. The ZG-mount is designed for mounting from the outside in a 21 mm dia. hole on horizontal surfaces as e.g. roof top or trunk lid.

The mount is provided with an M8 x 1 thread mount system. This construction meets the demand for a low-profile mobile mount with a slim appearance and with protection against theft of the antenna whip.

When cleaning the car in car-washing machines, the whip is easily removed using a spanner, size 12 mm. The whip is refitted again by screwing it onto the thread stud and tightening it with the spanner.

The MZG-mount antennas are provided with a large-diameter, thoroughly magnetized permanent ring magnet with an extraordinarily high attaching effect. A silicone layer applied to the whole contact surface protects the car roof and ensures maximum friction.

Please note that whips from the ZG/ZGP4 mounts and the whips from the MZG-mount are not compatible.

MECHANICAL	
MATERIALS	Whip: Black-chromed stainless steel and brass Mount: Black-chromed Weather- and shockproof plastics Stainless steel
RECOMMENDED INSTALLATION TORQUE	7.5 ± 1 Nm
COLOUR	Black
HEIGHT	Approx. 59 cm (dep. on freq.)
WEIGHT	ZG-version: Approx. 180 g ZGP4-version: Approx. 320 g MZG-version: Approx. 860 g
MOUNTING	ø21 mm dia. hole

1. INSTALLATION DIMENSIONS

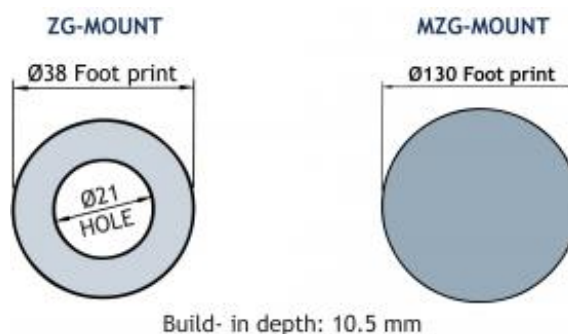

2. INSTALLATION STEPS

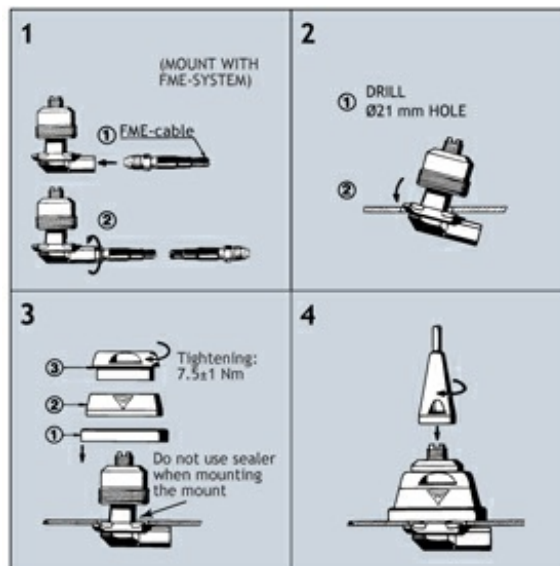

Do not use sealer on rubber gasket or other places.

3. TUNING

PLEASE NOTE

For safety reasons:
 When using the MU 4-MZG/..., car speed must not exceed 140 km/h.

MZG-models

